

THE INFORMATION CONTAINED IN THIS DOCUMENT IS PROPRIETARY TO Y-S ELECTRONIC, ANY REPRODUCTION IN PART OR WHOLE WITHOUT PRIOR WRITTEN APPROVAL OR AUTHORIZATION OF Y-S ELECTRONIC IS STRICTLY PROHIBITED.

RoHS COMPLIANT

REV.	DESCRIPTION	ECN NO.	DWN.	CHK.	APVD.	DATE
A			Xie	Fan	Zhou	2018.06.22

NOTES:

- 1. MATERIAL: Brass, T=0.20mm
- Electrical
- Contact Resistance : 20 milliohms
- Current Rating : 3 AMP
- Volatge Rating : 250 VAC/rms 60Hz
- Contact for AWG 24-26

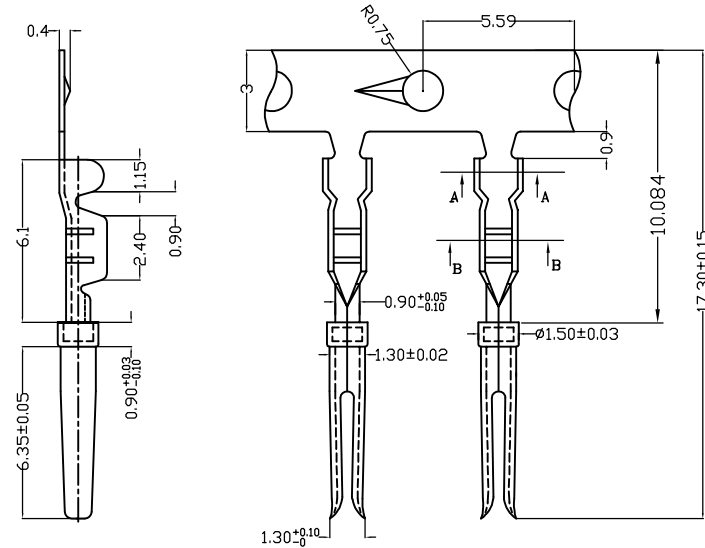
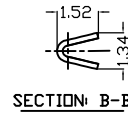
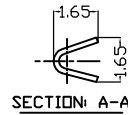

106 SERIES CRIMP TERMINAL

Ordering Information

Series No: 106 —

Contact Type:   
 1: Male      3: Male(phosphor bronze)   
 2: Female    4: Female(phosphor bronze)

Contact Plating:   
 1: Unplated   
 2: 1u" Selective Gold    4: 15u" Selective Gold   
 3: 30u" Selective Gold    5: 5u" Selective Gold   
 6: 2.5 μ" min gold over 12 μ" Pd-Ni   
 9: 1u" Selective Gold(soldering area Matte Tin)

Going-up Direction:   
 L: left hand Going-up Direction    N: nought direction   
 R: right hand Going-up Direction

Package :   
 1. 5K/Per Reel    3. 1K/PE BAG    5. 500/REEL   
 2. 10K/Per Reel    4. 500/BOX

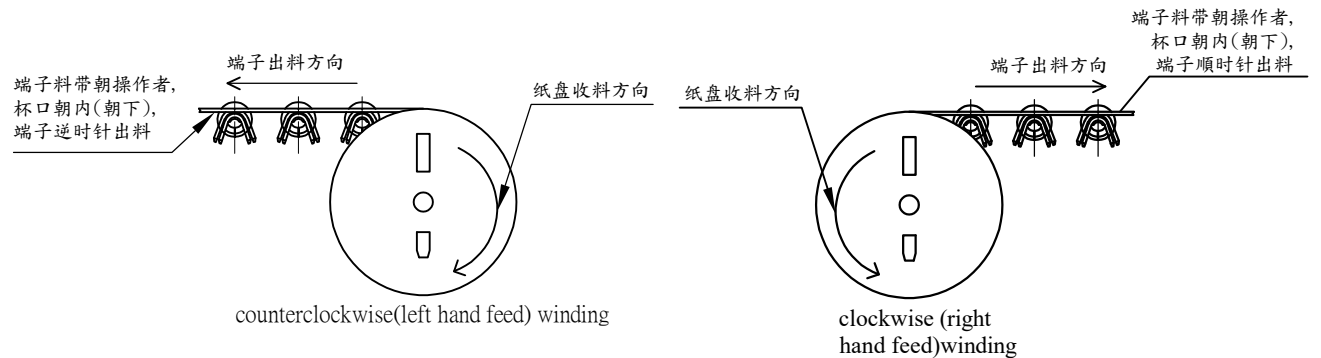

DIMENSIONS: <input type="checkbox"/> mm [INCH] <input type="checkbox"/> INCH [mm] <input checked="" type="checkbox"/> mm ONLY	CAD GENERATED DRAWING, DO NOT MANUALLY UPDATE DRAWN BY AND DATE TIAN 2011-10-14	
	UNLESS OTHERWISE SPECIFIED, GENERAL TOLERANCE: DECIMALS    ANGLES .X ±0.38 [0.015]    X° ±3° .XX ±0.25 [0.010]    .X° ±1.0° .XX ±0.13 [0.005]	
MATERIAL:		DRAWING NO.
FINISH:	SCALE: 1:1	SIZE: A4
FILE NO:		REV A
SHEET 1 OF 1		106-2XXX

DO NOT SCALE DRAWING